

# forrestchase

incorporating city central



## Specialty Mall Leasing Opportunities at Forrest Chase Shopping Centre

The Stats



**forrestchase**  
incorporating city central

---

2 MAJORS

---

39 SPECIALTY STORES

---

2 CML SITES

---

GLA 41,127 SQM

### About Forrest Chase Shopping Centre

Forrest Chase is located on the corner of Forrest Place and the Murray St Mall. It's the home to Myer, Ninewest, Cue, Dick Smith, Levi's, Creative Native and a range of over 40 specialty fashion and lifestyle

### Benefits of Mall Leasing

- Ability to promote your product or service outside your traditional trade area
- Benefit from operating within a proven retail environment, without the commitment of a permanent lease or set up costs
- Test unique concepts on new markets
- Build public awareness of your product or service

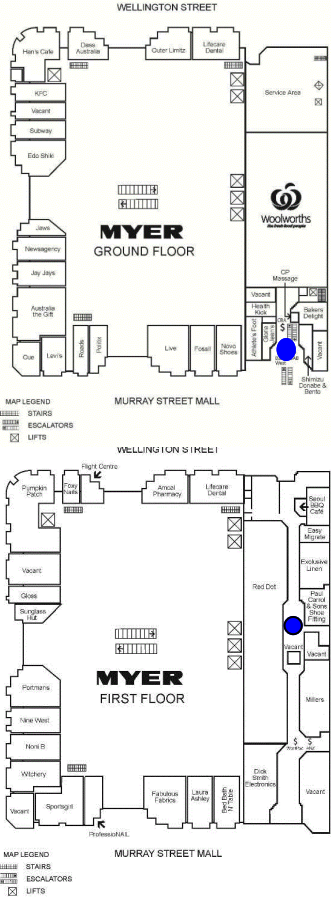

Location	Availability	Rate per week	Comments
Site 1	Weekly	\$1200 GST	Ground Outside Shimzu
Site 2	Weekly	\$1000 GST	First Floor outside Paul Carrol

**Centre Opening Hours**  
 Monday - Friday 8am - 9pm  
 Saturday 8am- 5pm  
 Sunday 11am - 5 pm